

The best of both worlds.
Now in yours.



For once life isn't all about
compromises.

The best life Salem has to offer can be yours if you choose it so. The most exclusive of neighbourhoods meets the most convenient of locations, giving you a home of absolute beauty that's specially made for a select few. Suham is designed for those who see life as a celebration and brings that joy to every moment.

- 3BHK apartments
- Spacious balconies on three sides
- Natural light and ventilation
- Earthquake Resistant Structure
- No Common Walls

presenting

 **Suham**
The good life gets better

- Vaastu Energy Compliant
- Teak Doors and Windows
- High Quality Branded materials used
- High End Full Auto SS Lift
- Water Softener Plant
- Generator Backup for common area
- One year free maintenance period
- Modular Kitchen
- Granite flooring for all Common Area
- CCTV with backup and live feed
- Lightning Arrester provided
- Intercom Access Control
- Key Hole Camera with Display on main doors



Red-carpet Treatment. For life.

With just five apartments, a Suham home might be desired by millions, but will be owned by a lucky handful. Your neighbours will be more like extended family, and living in the elegant KMS Gardens brings together the best of both worlds - quiet, serene living and proximity to the comforts of the city. Just the right environment for your loved ones. Come be a part of this life, where the good times never end.



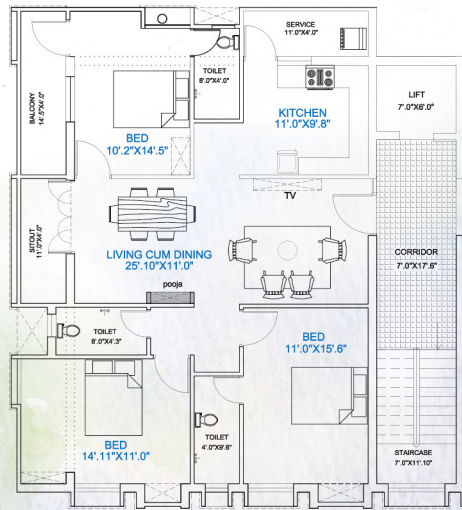

NORTH SIDE FLAT
(A1 3BHK, A2 3BHK & A3 3BHK)
FLAT AREA: 1348 Sq.Ft.
COMMON AREA: 222 Sq.Ft.
SALEABLE AREA: 1570 Sq.Ft.

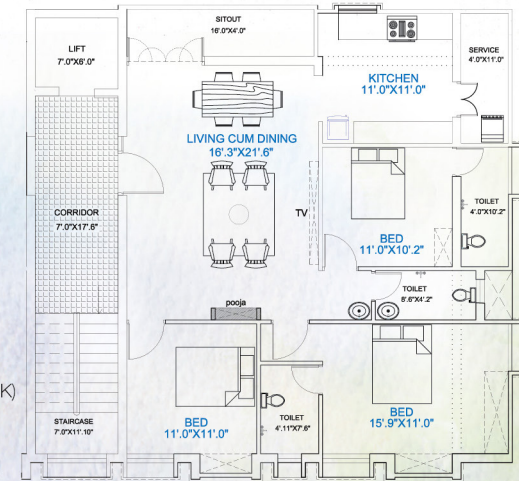

SOUTH SIDE FLAT
(B1 3BHK, B2 3BHK & B3 3BHK)
FLAT AREA: 1289 Sq.Ft.
COMMON AREA: 211 Sq.Ft.
SALEABLE AREA: 1500 Sq.Ft.



- 300 mts from Ramakrishna Road, 500 mts from Fair Lands and 400 mts from Brindavan Road
- Salem's commercial hub, best hospitals, railway station and bus-stand all within 2 kms radius
- Close to prominent institutions like Saradha college, Holy Angels, Cluny and St.Johns Schools





Suham is created by Nirmal Developers, which in turn is a venture of the renowned Brick Steel Enterprises. Backed by a legacy that spans over forty years and a construction portfolio of over twenty five lakh sq.ft.

We are passionate about - quality construction, value for money and well-discerned holistic spaces. We prefer to take care. We prefer to pay attention to the smallest details. We prefer to build homes of quality. For life.



For Bookings Call Satish **8754006556**



www.nirmaldevelopers.net

KMS garden 2nd street, Opp. Ramakrishna Road, Salem.